



Hyatts Wood Road, Backwell

Guide Price £599,950

 4  2  4



BESPOKE FEATURES - A wonderfully unique detached farmhouse style cottage offering four double bedrooms along with an additional two bedrooms within an attached self-contained annexe. EPC rating E.



Key Features

- A truly unique four bedroom detached cottage
- Amazing landscaped gardens with outdoor kitchen
- Open plan Kitchen/Dining/family room
- Many bespoke features
- Council Tax band E
- Plus self contained two bedroom annex with excellent income potential
- Gated driveway to workshop/garage plus parking for numerous vehicles
- Convenient position with flexible use
- Backwell School Catchment
- EPC rating E

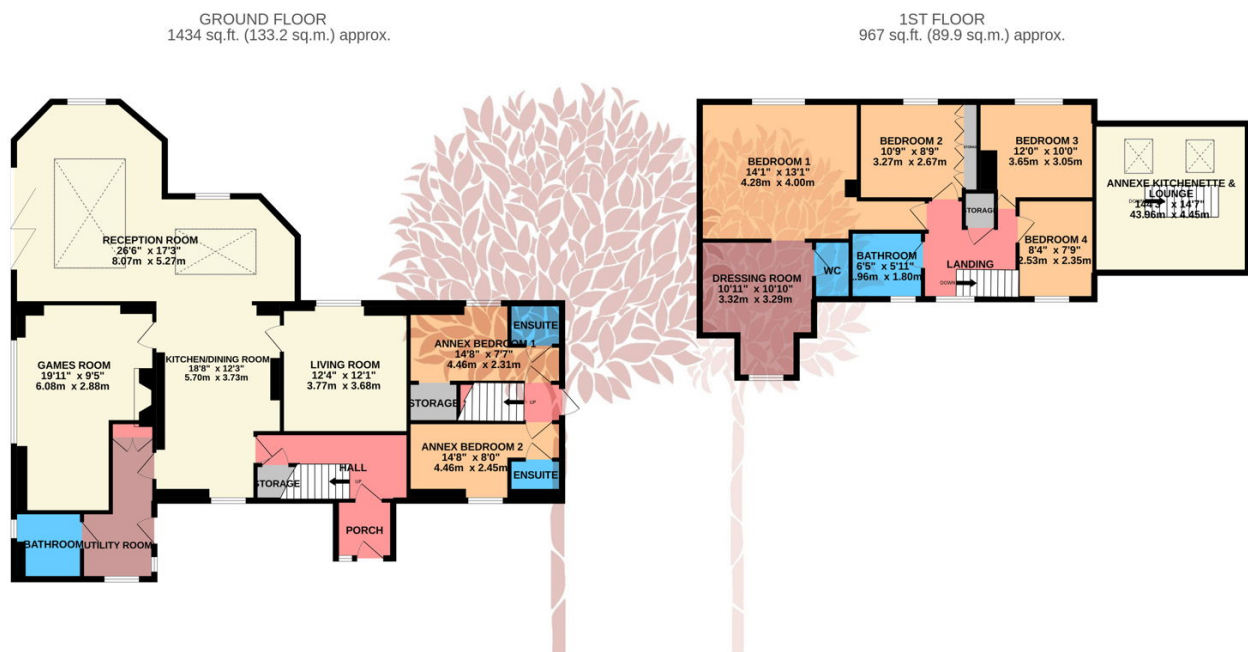

TOTAL FLOOR AREA: 2401 sq.ft. (223.0 sq.m.) approx.

Whilst every attempt has been made to ensure the accuracy of the floorplan contained here, measurements of doors, windows, rooms and any other items are approximate and no responsibility is taken for any error, omission or mis-statement. This plan is for illustrative purposes only and should be used as such by any prospective purchaser. The services, systems and appliances shown have not been tested and no guarantee as to their operability or efficiency can be given.
Made with Metropix ©2022.

